



*Elizabeth Furnace*  
~ 1 7 5 7 ~

WEDDING  
COLLECTION



# BECOME A PART OF OUR HISTORY

---

Registered as a National Historic Landmark by the United States National Park Service, Elizabeth Furnace transcends time by preserving the diligent craftsmanship of its 18th-century origin and adding the contemporary aesthetics of the modern age through its recent restorations. As you explore this Lancaster, Pa. property's private 33 acres, you will retreat into a different day and age. A day and age rooted in tradition and heritage all while staying grounded in the present with updated amenities and sleek additions. The enchanting, tiered lush Coleman Gardens; climate-controlled colonial-style Steigel Stable glowing with natural light; primitive Charcoal Barn set in a wooded glen; sprawling lush lawns lined with wildflower fields; and the charming 1700s mansion with grey stone patio and fire pit are just a few idyllic settings perfect for a distinguished wedding or first-class event. All play a part in creating the Elizabeth Furnace Experience.

*Elizabeth Furnace*  
~ 1 7 5 7 ~





FIRST TIME OPEN TO THE PUBLIC IN OVER 250 YEARS



In 1746, John Jacob Huber patented 400 acres of land in northern Lancaster County. Pictured on the right side of this photo is The Huber House - the oldest building on property. As early as 1750, John Jacob Huber had built and put in a blast furnace, where he cast five-plate stoves for the Pennsylvania market. Huber's daughter, Elizabeth, married one of his employees - a young German named Heinrich Wilhelm Stiegel. Heinrich Wilhelm Stiegel, William Stiegel or the Baron von Stiegel, is synonymous with some of the most highly collectible colonial-era decorative glass in America. Stiegel bought out his father-in-law's interest in Elizabeth Plantation in 1757 and with backing from wealthy Philadelphia investors, constructed most of the buildings that survive in the core of the campus today. Stiegel also rebuilt the furnace and renamed it Elizabeth Furnace for his wife. Centuries later, and we still honor that name today.



The Bell Tower's unique design and architecture has become an iconic spot on property. Back in the 1700s the bell's ring would notify the community about important gatherings and meal times. After 250+ years, it still operates today and is just one of several unique features to the Elizabeth Furnace Experience.

*YOUR ELIZABETH FURNACE  
EXPERIENCE AWAITS . . .*



## VENUE SPACES



### COLEMAN GARDENS

Originally designed as a formal English-inspired boxwood garden, the romantic, lush, tiered Coleman Gardens have been updated with a variety of flowering bushes, trees, and plants that provide picturesque scenery throughout any season. After your wedding vows, you and your guests can enjoy a garden cocktail hour complete with the garden's built-in Terrace Bar. The Coleman Gardens also allows tented options to offer you an outdoor garden wedding no matter the weather.



### GARDEN FOLLY

Colonial-style crushed stone walkways lead you through the Coleman Gardens up to the top tier that holds the beloved Garden Folly - a perfect setting within Coleman Gardens to share your, "I Do's." The Garden Folly is original to the property and has been meticulously mended and restored to provide a historic, one-of-a-kind background for your nuptials.



## STIEGEL STABLE

Historic, timeless, one-of-a-kind. The Stiegel Stable dates back to the 1760s and is a true English Style Stable that housed horses used for work and day-to-day operations at the furnace. The building has been meticulously repointed and restored with careful attention to ensure preservation of its historic integrity. The Stable is fully conditioned and has been updated with modern amenities (including USB charging ports in the concrete floor). The space features four large double-tiered chandeliers, numerous windows allowing an abundance of natural light to pour in, original stone walls, newly constructed restrooms, and outdoor terrace with firepit. You and your guests will dine, dance, and celebrate in this truly unique space as you create your own Elizabeth Furnace Experience.



## CHARCOAL BARN

The Charcoal Barn was the building that began the industrialization of the site and created Elizabeth Furnace. It's original timber frame is over two centuries old and provides an authentic charm to any event. It's large sliding barn doors open to reveal a repointed stonewall structure with romantic rays of natural light shining between the small slats between the wooden boards. The Charcoal Barn offers an indoor ceremony option and is a perfect location for a rehearsal dinner, bridal shower, or intimate wedding.



## STIEGEL-COLEMAN HOUSE

Poised, stately, and romantic - the Stiegel-Coleman House dates back to the mid 1700s and features a gorgeous wraparound porch, federal columns, charming stone architecture, and quaint colonial-style benches ideal for photos. The stunning architecture provides a beautiful backdrop for an intimate ceremony or swoon-worthy first look.



## BRIDAL PAVILION & GENTS QUARTERS

You and your wedding party can rest and relax as you get ready for the big celebration amongst our two distinct locations for wedding day preparations. The Bridal Pavilion is located in the Stiegel Stable and the Gents Quarters are located in an original stone building within Coleman Gardens. The Bridal Pavilion features a private bathroom, comfortable lounge seating, multiple make-up vanity settings, snack area, and a floor-to-ceiling wall of windows overlooking the pond and wildflowers. The Gents Quarters offers a cozy lounge area, area for attire, dry bar, and fireplace.



## COLEMAN CHAPEL

Placed directly across the road from Elizabeth Furnace, the Coleman Chapel offers a quaint setting for an indoor ceremony option. The chapel was built in 1877 in loving memory of James Coleman. Coleman Chapel features Tiffany stained glass windows, vaulted ceilings, and comfortable seating for up to 135 guests.

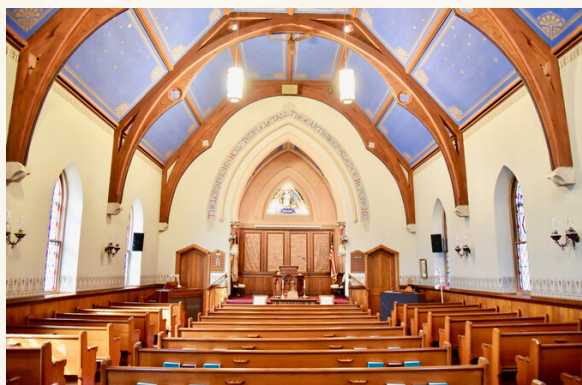

## WHIMSY WOODLANDS

Elizabeth Furnace offers un-ending locations for picturesque photos. Part of the property features dense whimsical woodlands with an organic grass pathway running through it. Long ago, this grass pathway used to be the Old Rt. 501 or Lancaster Pike used by travelers in horse and buggies. Today, it serves as a unique natural setting perfect for sunset photos and capturing moments that you will cherish forever.











## VENUE INCLUSIONS

- Private Access to a Registered National Historic Landmark for your wedding - *first time being open to the public in over 250 years*
- Fully Private Property - 33 acres of lush native and manicured grounds
  - *You will be the only special event on property on your wedding day!*
- Exclusive use of multiple locations on property including:
  - *For Photos:*
    - Coleman-Stiegel House Porch
    - Coleman-Stiegel House Stone Patio with Fire Pit
    - Historic Huber House
    - Whimsy Woodlands
  - *For Event Use:*
    - Tiered Coleman Gardens with Garden Folly
    - Charcoal Barn
    - Stiegel Stable
    - Ice House with Bridge
    - Garden Terrace Bar
    - Bridal Pavilion
    - Gents Quarters
- Option for use of Coleman Chapel for wedding ceremony service (additional fee applies)
  - *Coleman Chapel features Tiffany Windows and Seating for up to 135 Guests*
- Exclusive use of the property for up to 12 hours on your wedding day - from check in to end of reception
  - *Event timeframe is based on a 6 hour event timeline*
  - *Additional time can be added on for a fee*
- Complimentary 2 hours on property for engagement photos
- Complimentary 1 hour on property for rehearsal of ceremony prior to the wedding day - *To be scheduled one month prior to wedding date*

- Options for outdoor / indoor ceremony
  - *Indoor Charcoal Barn ceremony space available for additional setup/rental fee*
  - *Available as a cocktail hour space as well or rehearsal dinner location option*
- Stone Terrace and Firepit Located Outside of Stiegel Stable Pond Water Feature with Fountain
- Fully climate controlled and flexible reception space in the Stiegel Stable for up to 160 guests with dance floor
- Brand new restrooms with ADA accessibility
- Fully furnished wedding preparation areas
  - *Contemporary glass Bridal Pavilion overlooking wildflower fields and pond - includes private bathroom, full amenities needed for hair and makeup preparations, mini fridge, lounge seating, mirrors*
  - *Historic Gents Quarters located in the Coleman Gardens - fully furnished lounge setting with mini fridge and dry bar*
- Paved, landscaped, and well lit parking area for guests
  - *Parking attendant included*
- Golf Cart Transport Service Around Property as Needed
- Ambient lighting throughout the entire campus
- Colonial-style crushed stone walkways with landscaped seating areas throughout the campus
- Preferred Vendors List and Local Accommodation Guide Provided for Planning Assistance
- Climate Controlled Facilities for Caterer



## INCLUSIONS *cont'd*

### DESIGN / RENTAL / DECOR

#### INCLUSIONS:

- 200 Fruitwood Chiavari Chairs with Ivory Cushions
- 200 White Plastic Folded Chairs with Padded Seat for Ceremony
- 5' Round Guest Seating Tables
- 30" Round Cocktail Tables
- 8' Rectangular Tables for Escort Card, Gift, and DJ
- All Tables Accompanied with Specialty Linens
  - Varying color options dependent on date availability
- Setup and Breakdown of Rental Items
- Tabletop Inclusions: China, Flatware, Linen Napkins, Stemmed Water Glasses, Carafe of Spring Water, Salt & Pepper, Votive Candles with Tealights
- Bar & Beverage Glassware: Highball, Rocks, Martini, and Stemmed Glassware
- Linens and Decor custom designed for DJ, Cake, Gift, Cocktail, Escort Card, Food Station, and Coffee Tables
- General decor to match your theme highlighted on these specialty tables and bar areas
- Custom Designed Fresh Flower Arrangement for Any and All Food Station(s)

### FOOD & BEVERAGE INCLUSIONS

- Choice of Personalized Menu Collection from Internationally Awarded Catering Team
- Every menu to include a fully developed menu comprised of hors d'oeuvres, salad course, assorted breads course, dual entree course with accompaniments, coffee and tea service
- Variety of service styles available - Seated/Served Meal, Stationed, Cocktail Reception, Buffet, Family Style
  - *Variety of tiered pricing options*
- Options for Menu Enhancements such as late night snacks or dessert stations
- Full Bar Mixer Package
  - *Non-alcoholic beverages include: Coke, Diet Coke, Sprite, Ginger Ale, Tonic, and Club Soda*
  - *Beverage Accompaniments: Orange, Cranberry, and Pineapple Juices, Lemons, Limes, Olives, and Cherries*
- All alcohol supplied by client
- Complimentary Tasting Event for up to Four Guests

### SERVICE INCLUSIONS

- An Event Manager and Service Personnel dashingly dressed in black bistro attire will fully setup and break down food service during the reception
- One gracious staff member specifically appointed to service the couple - *during the event timeline*
- Professional Culinary Team Members at your event
- Personal consultations are included to ensure that your vision is executed down to the smallest detail
- Portable kitchen equipment and trash removal service included
- Complimentary champagne glasses and champagne service for toasting purposes
- Complimentary cake cutting and service with cake plate and dessert fork included
  - *Wedding cake supplied by client*
- Tip or Ramp Certified Bartenders to setup and breakdown, liquor liability, and ice and bar equipment



# LAYOUT EXAMPLES

## LAYOUT 1

Stiegel Stable - Sample Seated Reception for 150 guests

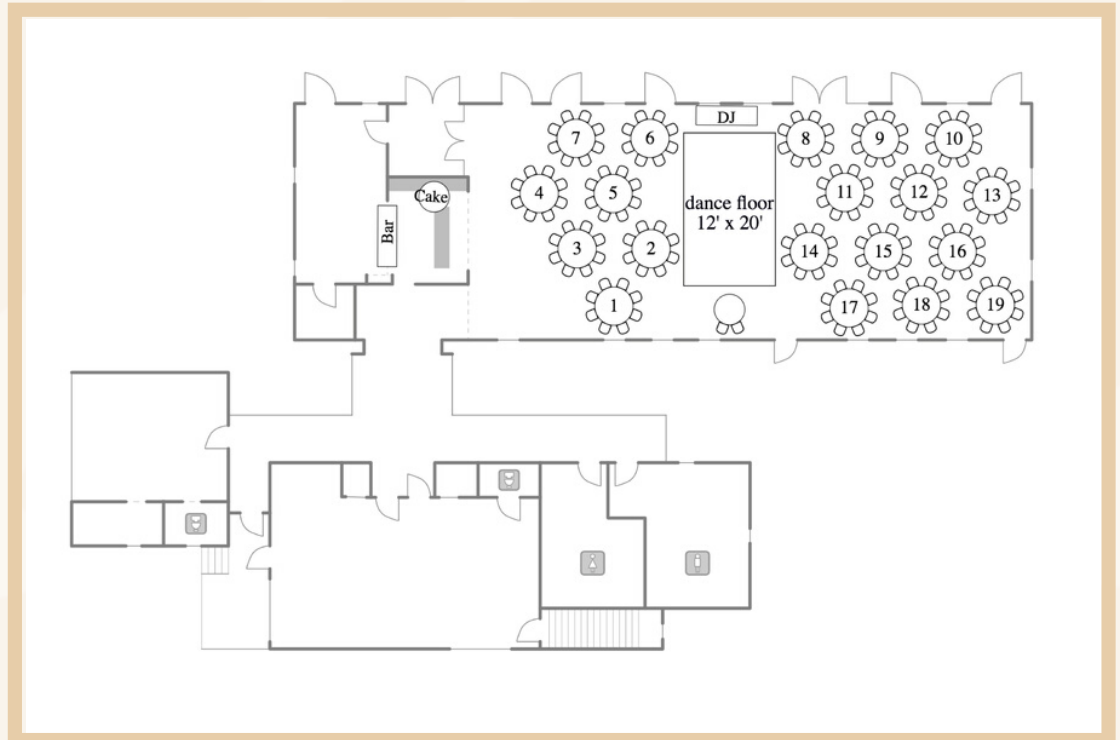

## LAYOUT 2

Charcoal Barn - Sample Ceremony seating for up to 180 guests

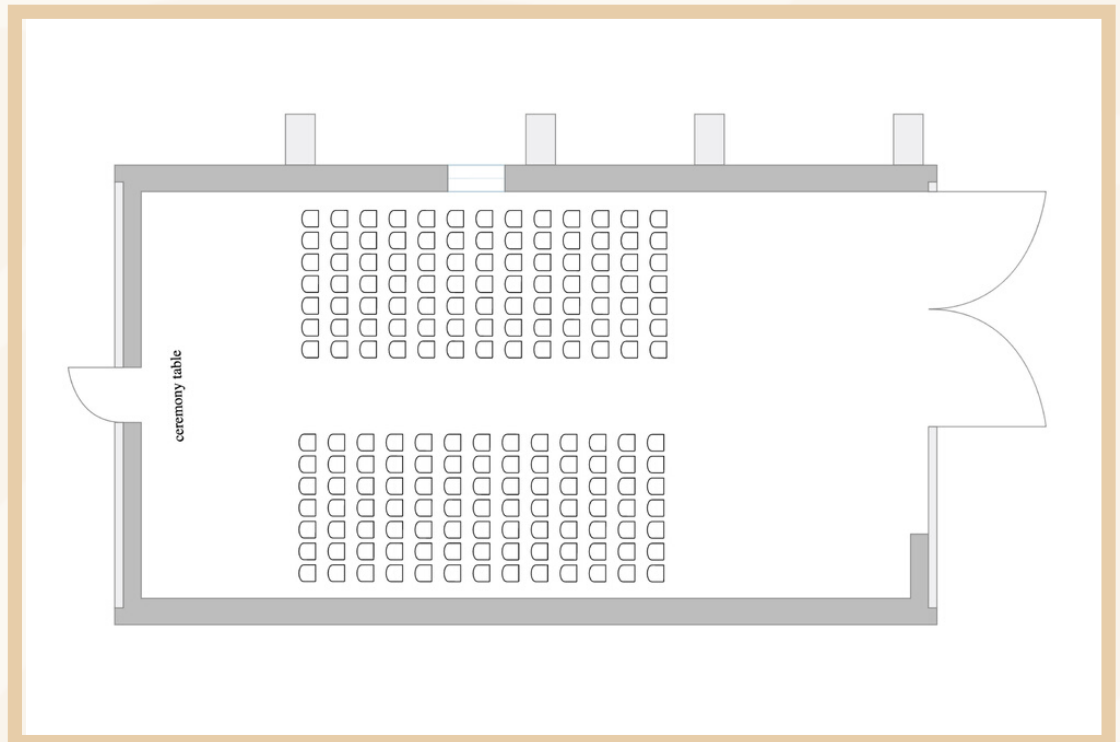



# *Elizabeth Furnace*

~ 1 7 5 7 ~

2121 Furnace Hills Pike, Lititz, PA  
elizabethfurnace.com | 717-723-9480  
events@elizabethfurnace.com  
@elizabethfurnaceevents

